

>>>

SPACE-SAVING
PANEL IN YOUR HAND



PV035-TST/TNT ; PV037-LST/LNT ; PL037-LST ; PL035-TST ; PL057-LST/TST

Knowing that the small size Touch panels are widely requested, Cermate develops PV037/035 series after releasing big size screens. The small size screens using the same accommodative Software "PanelMaster" as the big size screen, are not only compact but save wiring efforts. The PV/PL series is a low budget entry level HMI for simple applications equipped with necessary basic functions. It is a high function but cost effective HMI which can communicate with popular programmable controllers. Rugged plastic housing, IP65 equivalent front panel and fanless 32 bits CPU make the PV/PL series a reliable solution for industrial or critical applications. The customized membranes, logos for all models from 3.5" to 15" Touch Panel meet your demands and welcomed widely in such as Factory Automation, Building Automation, Specified machine tools etc...

FEATURES

- High Quality Control and 100% Product Test.
- IP65F Equivalent Front Panel with Touch.
- Built-in Fanless, Reliable and High Function RISC 32-bits CPU.
- Provides dual serial communication ports, some models provides Ethernet communication.
- Provides 160x80 wide viewing angle, 16 grays, 320x240, 256 colors TFT LCD module.
- Provides long life white LED backlight.
- Optional from 128KB/512KB/1MB battery backup memory for Alarm, Recipe, Data Recording.
- Supports Multi-Languages, Windows Unicode & BMP, JPG, WMF, GIF graphic formats.
- Provides accommodative Software, "PanelMaster".
- Customized Logo / Membrane Design and BIOS for users to display company names.

SPECIFICATIONS

Model No.	PL037-LST	PV037-LST	PV035-TST	PL035-TST	PL057-TST	PL057-LST
		PV037-LNT	PV035-TNT			
Display Size	3.7" diagonal		3.5" diagonal		5.7" diagonal	
Display Type	STN monochrome 16 gray colors		Color TFT 256 colors			STN 16 gray colors
Resolution (Pixels)	160 × 80 Pixels		320 × 240 Pixels			
Display Contrast	Contrasted via V.R. from the back					
Backlight life	LED backlight, 50,000 hrs(room temp.:25°C, humidity85%RH)					
Touch panel	Hardness/4H, 4-wire analog resistance, 1 million activation minimal under normal temperature lower than 200 gm force					
Power supply	24VDC±10% Isolated; power consumption lower than 10W					
CPU	RISC ARM 32Bit CPU					
Flash memory	1M Bytes	1M Bytes	4M Bytes	2M Bytes	2M Bytes	
System working SRAM	256K Bytes	256K Bytes LNT:1M Bytes	TST: 1M Bytes TNT: 2M Bytes	512K Bytes	512K Bytes	
Battery backup/RTC	X	128K ~1M Bytes (Optional)		X		
Communication port	PV type: COM1/9pin: RS232/RS422/RS485 COM2/Terminal 4pin : RS422/RS485			PL type: COM1/9pin: RS232 COM2/Terminal 4pin : RS422/RS485		
Extension port	None					
Ethernet port	X	Yes(N type)	Yes(N type)	X	X	
Storage temperature	-20°~ 60°					
Environment	Operating temperature	0°~50°				
	Relative Humidity	10%~90%				
	Shock (Operation)	10 to 55Hz (X, Y, Z 方向) 1GHz, 30 mins shock testing)				
	EMI	Complies with FCC Part 15 Class B				
	CE	Complies with EN50081-2 and EN50082-2 standards				
	Front panel	Meets NEMA4/IP65				
Certifications	CE, FCC					
Outlet mm (W x H x D)	130.0 x 106.2 x 37				186.6 x 145.7 x 42	
Cutout mm (W x H)	118.5 x 92.5				174.5 x 132.5	
Net weight (K.G)	0.32KG		0.45 KG		0.6 KG	
Power consumption	6W		8W		10W	

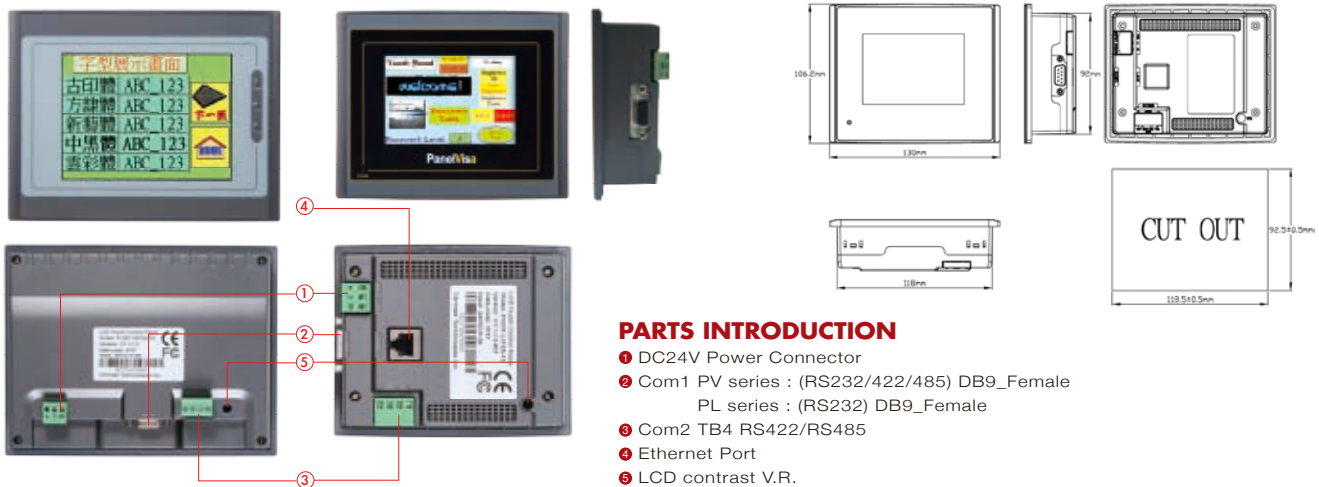

PARTS INTRODUCTION

- ① DC24V Power Connector
 - ② Com1 PV series : (RS232/422/485) DB9_Female
PL series : (RS232) DB9_Female
 - ③ Com2 TB4 RS422/RS485
 - ④ Ethernet Port
 - ⑤ LCD contrast V.R.
- All the specifications and photos are subjected to be changed without notice.

PanelVisa Industrial Touch Panel

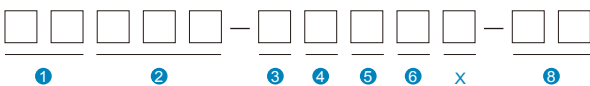

Taiwan: Cermate Technologies Inc.
 China: Shenzhen Cermate Technologies Inc.

ORDERING INFORMATION:

- ① Model : PV/PL Series ; RISC 32 Bit CPU
- ② LCD Size : 037 = 3.7 Inches ; 035 = 3.5 Inches ; 057 = 5.7 Inches
- ③ LCD Spec.:
L= Monochrome STN LCD, 16 gray levels with LED backlight
T= TFT 256 colors levels LED backlight
- ④ CPU I/O Specification :
S=Serial Ports ; N=LAN Port
- ⑤ Operation Type : T=Touch Panel ; K=Function Key
- ⑥ CPU Board Port Specification : 2=standard type with 2 Serial Ports
- ⑦ Case Color : B0=black ; C0=white ; F0=sliver black ; G0=sliver white